

φ50mm

SPUR GEARHEAD (正齿轮箱) w/
42ZYT PM DC MOTOR (永磁直流马达)



● GEARHEAD SPECIFICATIONS

Gear Ratio	Stage	Eff.	Rated Load	Max. Load	Length	
减速比	级数	效率	额定负载	最大负载	长度	
1:X	#	%	Kg.cm	Kg.cm	mm	
8	14	2	81	10	20	26
33	55	3	73	20	40	26
130	220	4	66	30	60	33.5
520	883	5	59	30	60	33.5

● DIMENSIONS

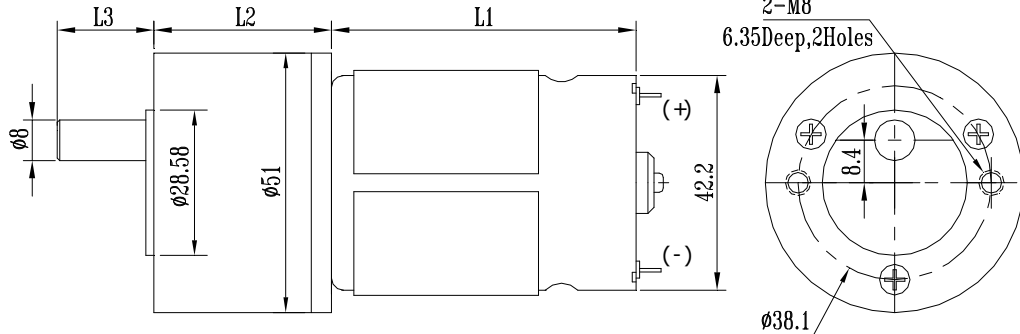

● MOTOR SPECIFICATIONS

Model	Rated	No-load		Rated				Stall	Motor	
	Voltage	Current	Speed	Current	Speed	Torque	Power	Torque	Dia.	Length
	VDC	A	r/min	A	r/min	g.cm	W	g.cm	mm	mm
42ZYT67-12-25	12	0.2	2500	0.9	1850	300	5.7	1.2	42.2	67
42ZYT67-12-38	12	0.25	3800	1.8	2900	375	11.2	1.6	42.2	67
42ZYT67-12-50	12	0.55	5000	2.94	4200	460	19.8	2.8	42.2	67
42ZYT67-24-25	24	0.15	2500	0.45	1850	300	5.7	1.2	42.2	67
42ZYT67-24-38	24	0.13	3800	0.9	2900	375	11.2	1.6	42.2	67
42ZYT67-24-50	24	0.25	5000	1.46	4200	460	19.8	2.8	42.2	67

● GEARMOTOR SPECIFICATIONS 50JB30KxxxG-Motor Model

(IN-LB) = 0.867313*X(Kg.cm)

Volt.	Speed	Gear Ratio	8	14	32.5	55	130	220	520	883
		Efficiency %	81	81	73	73	66	66	59	59
12 Vdc	2500	No-load speed (RPM)	313	179	77	45	19.2	11.4	4.8	2.8
		Rated speed (RPM)	231	132	57	34	14.2	8.4	3.6	2.1
		Rated load (Kg.cm)	1.94	3.40	7.12	12.05	25.7	30	30	30
	3800	No-load speed (RPM)	475	271	117	69	29.2	17.3	7.3	4.3
		Rated speed (RPM)	363	207	89	53	22.3	13.2	5.6	3.3
		Rated load (Kg.cm)	2.43	4.25	8.90	15.06	30	30	30	30
	5000	No-load speed (RPM)	625	357	154	91	38.5	22.7	9.6	5.7
		Rated speed (RPM)	525	300	129	76	32.3	19.1	8.1	4.8
		Rated load (Kg.cm)	2.98	5.22	10.91	18.47	30	30	30	30
24 Vdc	2500	No-load speed (RPM)	313	179	77	45	19.2	11.4	4.8	2.8
		Rated speed (RPM)	231	132	57	34	14.2	8.4	3.6	2.1
		Rated load (Kg.cm)	1.94	3.40	7.12	12.05	25.7	30	30	30
	3800	No-load speed (RPM)	475	271	117	69	29.2	17.3	7.3	4.3
		Rated speed (RPM)	363	207	89	53	22.3	13.2	5.6	3.3
		Rated load (Kg.cm)	2.43	4.25	8.90	15.06	30	30	30	30
	5000	No-load speed (RPM)	625	357	154	91	38.5	22.7	9.6	5.7
		Rated speed (RPM)	525	300	129	76	32.3	19.1	8.1	4.8
		Rated load (Kg.cm)	2.98	5.22	10.91	18.47	30	30	30	30