

90W AC Induction/Reversible Motor (交流马达) w/ Speed Control, Brake (速度控制, 电磁刹车)

● Motor Dimensions:

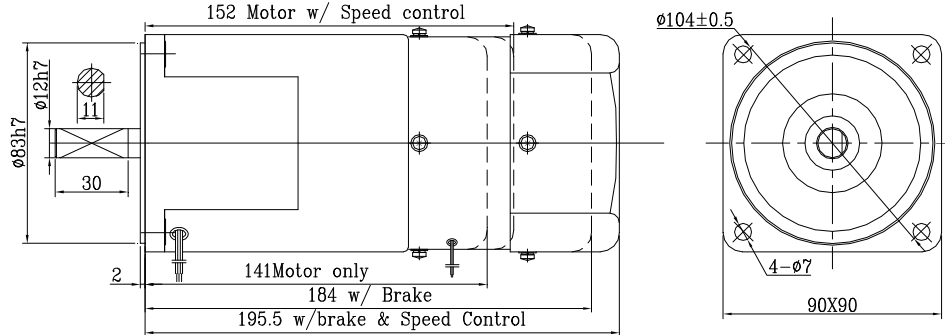

● Motor Specifications:

$Y(\text{in-lb}) = 0.867313 * X(\text{Kg.cm})$

Model	Type	Power		Poles	Phase	Volt	Freq.	Rated				Starting Torque		Duty	Capacitor	
		W	HP					Speed	Current	Torque		mNm	kg-cm		uF	Vac
								RPM	Amp	mNm	kg-cm					
90IK90-4S11-6	Induction	90	1/8	4	1	110	60	1550	1.40	540	5.51	450	4.59	Cont.	20	250
90IK90-4S22-5		90	1/8	4	1	220	50	1350	0.70	640	6.53	480	4.89	Cont.	5	450
90IK90-2S22-5		90	1/8	2	1	220	50	2800	0.79	300	3.06	340	3.47	Cont.	6	450
90IK90-4T22-5		90	1/8	4	3	220	50	1300	0.66	660	6.73	2400	24.47	Cont.		
90IK90-2T38-5		90	1/8	4	3	380	50	1300	0.38	660	6.73	2400	24.47	Cont.		
90RK90-4S11-6	Reversible	90	1/8	4	1	110	60	1550	1.55	540	5.51	480	4.89	30Min.	25	250
90RK90-4S22-5		90	1/8	4	1	220	50	1350	0.76	640	6.53	610	6.22	30Min.	6	450

Model	Type	Power	Range	Poles	Phase	Volt	Freq.	Rated Torque				Starting Torque		Duty	Capacitor	
								1200 RPM		90 RPM		mNm	kg-cm		uF	Vac
								W	RPM	mNm	kg-cm	mNm	kg-cm	mNm		
90IK90-4S11-6	Speed Control	90	90 ~	4	1	110	60	710	7.24	230	2.35	450	4.59	Cont.	20	250
90RK90-4S11-6		90	1600	4	1	110	60	750	7.65	250	2.55	330	3.37	30Min.	25	250
90IK90-4S22-5		90	90 ~	4	1	220	50	710	7.24	230	2.35	480	4.89	Cont.	5	450
90RK90-4S22-5		90	1400	4	1	220	50	750	7.65	250	2.55	330	3.37	30Min.	6	450

● Capacitor Dimensions:

Capacity	Voltage	L ± 1	W ± 1	H ± 1
uF	VAC	Mm	mm	mm
5	450	47	22	34
6	450	47	26	38
20	250	68	32	56
25	250	68	32	56

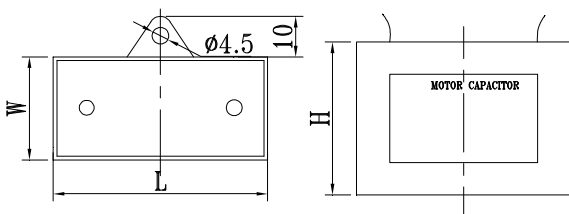

● Wiring Diagrams:

