

**φ27mm**

**SPUR GEARHEAD (正齿轮箱) w/  
28ZYT PM DC Motor (永磁直流马达)**



**● GEARHEAD SPECIFICATIONS**

Gear Ratio		Stage	Eff.	Rated Load	Max. Load	Length
减速比		级数	效率	额定负载	最大负载	长度
1:X		#	%	Kg.cm	Kg.cm	mm
30	39	4	66	1.5	4.5	17.1
75	97	5	59	2.0	6	19.6
187	244	6	53	2.5	7.5	22.1
468	610	7	48	2.5	7.5	24.6

**● DIMENSIONS**

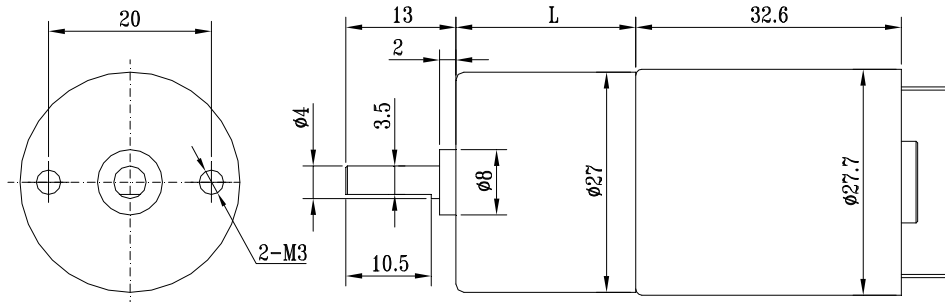

**● MOTOR SPECIFICATIONS**

Model	Rated	No-load		Rated				Stall	Motor	
	Voltage VDC	Current A	Speed r/min	Current A	Speed r/min	Torque g.cm	Power W	Torque g.cm	Dia. mm	Length mm
28ZYT33-12-40	12	0.035	4050	0.11	3080	22	0.7	256	27.7	32.6
28ZYT33-12-58	12	0.08	5800	0.23	4340	32	1.4	410	27.7	32.6
28ZYT33-12-75	12	0.1	7500	0.33	5760	36	2.1	525	27.7	32.6
28ZYT33-24-40	24	0.025	4000	0.07	3000	29	0.9	290	27.7	32.6
28ZYT33-24-55	24	0.04	5500	0.12	4200	36	1.6	410	27.7	32.6
28ZYT33-24-81	24	0.07	8100	0.21	6160	43	2.7	700	27.7	32.6

**● GEARMOTOR SPECIFICATIONS 27JA2.5KxxxG-Motor Model Y (IN-LB) = 0.867313\*X(Kg.cm)**

Volt.	Speed	Gear Ratio									
		30	39	75	97	187	244	468	610		
12 Vdc	4050	No-load speed (RPM)	135	104	54	42	21.7	16.6	8.7	6.6	
		Rated speed (RPM)	103	79	41	32	16.5	12.6	6.6	5.0	
		Rated load (Kg.cm)	0.44	0.57	0.97	1.26	2.5	2.5	2.5	2.5	
	5800	No-load speed (RPM)	193	149	77	60	31.0	23.8	12.4	9.5	
		Rated speed (RPM)	145	111	58	45	23.2	17.8	9.3	7.1	
		Rated load (Kg.cm)	0.63	0.82	1.42	1.83	2.5	2.5	2.5	2.5	
	7500	No-load speed (RPM)	250	192	100	77	40.1	30.7	16.0	12.3	
		Rated speed (RPM)	192	148	77	59	30.8	23.6	12.3	9.4	
		Rated load (Kg.cm)	0.71	0.93	1.59	2.0	2.5	2.5	2.5	2.5	
	24 Vdc	4000	No-load speed (RPM)	133	103	53	41	21.4	16.4	8.5	6.6
			Rated speed (RPM)	100	77	40	31	16.0	12.3	6.4	4.9
			Rated load (Kg.cm)	0.57	0.75	1.28	1.66	2.5	2.5	2.5	2.5
5500		No-load speed (RPM)	183	141	73	57	29.4	22.5	11.8	9.0	
		Rated speed (RPM)	140	108	56	43	22.5	17.2	9.0	6.9	
		Rated load (Kg.cm)	0.71	0.93	1.59	2.0	2.5	2.5	2.5	2.5	
8100		No-load speed (RPM)	270	208	108	84	43.3	33.2	17.3	13.3	
		Rated speed (RPM)	205	158	82	64	32.9	25.2	13.2	10.1	
		Rated load (Kg.cm)	0.85	1.11	1.90	2.0	2.5	2.5	2.5	2.5	